

# 210mm

# 290mm

### CZĘŚĆ 3 Cechy konstrukcyjne

Opryskiwacz wykonany jest z kompletnego materiału. Struktura opryskiwacza jest dobrej jakości, a projekt jest nowatorski, nie wymaga wielkiej siły oraz posiada wysoką wydajność. Wygodna konstrukcja sprawia, że długotrąle użytkownia nie sprawia żadnych problemów ani nie powoduje większego zmęczenia.

-3-

Capacity of the reagent box: 18L  
Working pressure: 0.2-0.4Mpa

## Instruction Manual for 18 Liter sprayer



-1-

### PART1 Use and application.

The knapsack 18Liter sparyer manual sprayer is a new generation product that is developed by our company. The product, which is complete sealed plastic, has cost saving, safety, high efficiency and leakage prevention. It is designed by concentrating on the advantages of all the same imported types. It can be widely used for the prevention of the diseases, pests and weed for grain, cotton, vegetable, fruit plant, etc. It can also be used for the sanitary pest killing and disinfection of environment in poultry, house and public places.

### PART2 Structural characteristics

1	Spray rod	15	Rubber cap
2	Nut of spray rod	16	Buckle of switch
3	Orifice expansion sleeve	17	Strap
4	Rubber ring	18	Rocker
5	Rubber ring	19	Air chamber
6	Rubber pipe	20	Reagent box
7	Rubber pipe cap	21	Felt gasket
8	Core of rubber pipe	22	Sleeve of rocker
9	Strap buckle	23	Pressure over of air chamber
10	Strap hook	24	Filter of reagent box
11	Str buckle	25	Fixed clamp of rocker
12	Pump	26	Retainer pin
13	Sealed ball	27	Reagent box cover
14	Sealed valve	28	Nut of shower

### Structural diagram of new 18 Liter sparyer complete airtight plastic sprayer

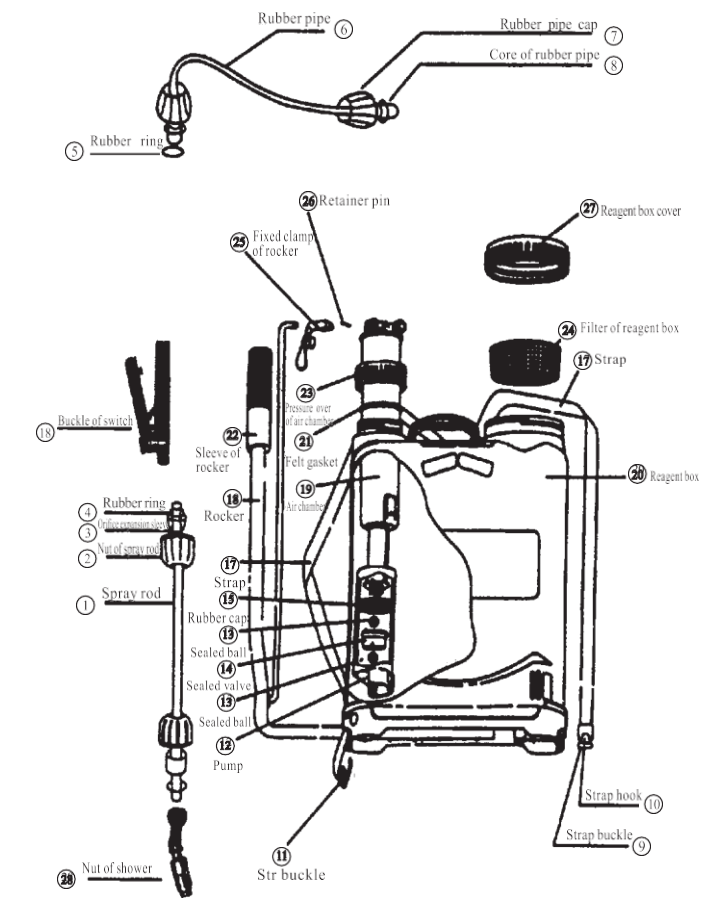

-2-